

S6 GYRO

3 CHANNEL REMOTE CONTROL HELICOPTER

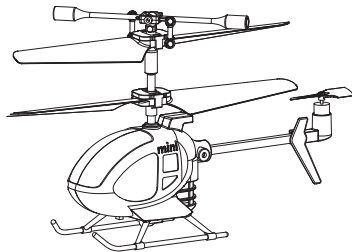

1 INSTRUCTION MANUAL

IMPLEMENT STANDARD: GB/T26701-2011

Helicopter Features

- Special Plastic frame for a good resistance to mill and stable flight. It is suitable for indoor flight.
- A sophisticated built-in gyroscopic auto-stability system for smooth and stable flying.
- Model design structured, easy operation and maintenance.

All material, dimensions and spare parts included in this instruction are for reference only. The company is not responsible for any changes printed parts and notify consumer. Any updated or changed please refer to our website www.symatoys.com.

BUTTON Description

A/B band selector: system regards to band "A" when controller turned on. press button "A" for 2 seconds till indicator lights flash twice, controller enter into bank "B", press button "A" for 2 seconds, indicator lights flash one time, controller back to band "A".

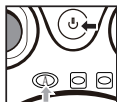

HELICOPTER CHARGING

Charging helicopter with USB: Take out the USB charging wire, connect the USB wire to the computer interface, then connect the other USB charging wire to the helicopter interface. During charging, the indicator of USB charging wire will be OFF. When it fully charged, the indicator will be ON.

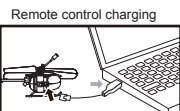

Charging time: about 25 - 30 minutes — Flying time: about 5 - 6 minutes!

Note: Make sure helicopter power switch to OFF position when charging.

TROUBLE SHOOTING

Problem	Reason	Solution
No response from the helicopter	1. Insufficient power with the helicopter. 2. Insufficient power with the transmitter, power indicator keeps flashing. 3. The band of the transmitter does not correspond to the decoding of the helicopter.	1. Please charge to the helicopter. 2. Replace the battery inside the transmitter. 3. Adjust the band on the transmitter and keep it the same as the helicopter.
If the helicopter is slow to respond or difficult to maneuver	1. Insufficient power with the transmitter. 2. Transmitter of the same frequency is used nearby.	1. Replace the battery. 2. Use the helicopter out of the range of other RC helicopters.

ABOUT CONTENTS

Product included following contents:

- Helicopter
- Transmitter
- Tail blade
- Instruction manual
- USB cable

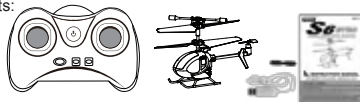

GET TO KNOW YOUR TRANSMITTER

Remoter instruction

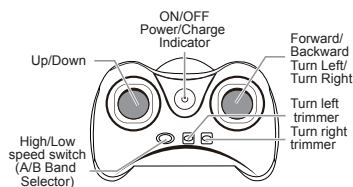

Battery Installation

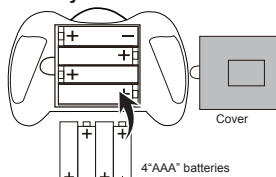

Unscrew and remove battery cover from R/C unit, insert 4 "AAA" batteries, noting polarity indicator. Replace battery cover.

-1-

BREAKDOWN & DIAGRAM

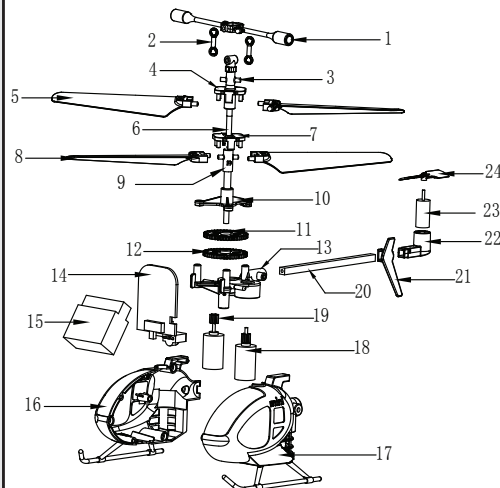

-5-

READY TO FLY YOUR HELICOPTER

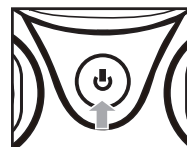

Step 1: Press the power switch to turn on the transmitter.

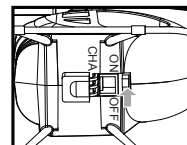

Step 2: Turn on your helicopter.

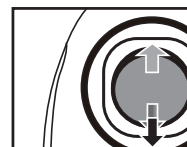

Step 3: Transmitter indicator blinks for about 10-20 seconds to match signal. When finish matching, it keeps light on, please push the left lever backwards to ready flight.

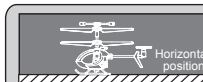

TIPS: When matching signal, keep the helicopter on horizontal position for faster matching and starting start a stable flight.

-2-

FLIGHT CONTROL

Hover up and down

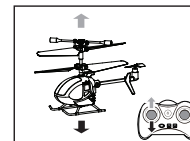

When the helicopter flies steadily, you can slowly push the throttle stick up to make helicopter fly higher, or release the stick a bit to make helicopter fly lower. Only small amounts of stick position change are required for smooth flying.

Forward and backward

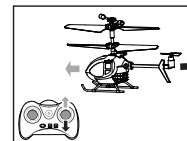

When you push up the right control lever (steering rudder), the nose incline to down, the helicopter is moving to forward. When you push down the right control lever (steering rudder), the nose incline to up, the helicopter is moving to backward.

Turn Left and Right



Hold the helicopter at a height. Push the rudder stick toward left to turn counter clockwise, and push the rudder stick toward right to turn clockwise.

Turn right/left calibration trim

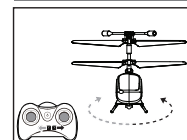

If helicopter rotates counter-clockwise... Continually push right R/C calibration until excessive turning stops. If helicopter rotates clockwise... Continually push right R/C calibration until excessive turning stops.

-3-

Code	Description	Quantity	Code	Description	Quantity
01	Balance bar	1	13	Under main stand	1
02	Connector buckle	2	14	Receiver board	1
03	Main shaft base	1	15	Battery	1
04	Top blades locker	1	16	Left body	1
05	Top blades	2	17	Right body	1
06	Spindle	1	18	Top blades locker main motor	1
07	Below blades locker	1	19	Below blades locker main motor	1
08	Below blades	2	20	Tail tube	1
09	Below blades base	1	21	Tail dangling	1
10	Top main stand	1	22	Tail cover box	1
11	Top blade gear	1	23	Tail motor	1
12	Under blade gear	1	24	Tail blade	1

SPARE PARTS

All the spare parts below can bought from local distributor.

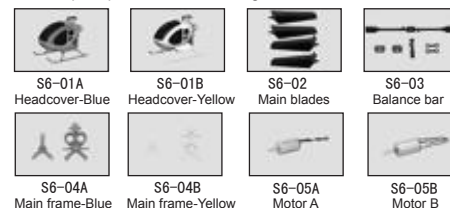

-6-

MAIN PARAMETER

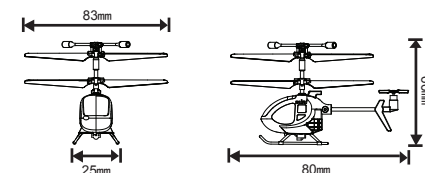

SPECIFICATIONS AND COLORS OF CONTENTS MAY VARY FROM PHOTO.

-7-